

STANDARD ENCAPSULATED

| Format | Power | Weight |
|-----------|-------|----------|
| EI44/14.5 | 6 VA | 220 grs. |

| Code | Primary | Secondary | Ta/DT/CT | Primary Protection | Secondary Protection |
|---------|---------|---------------|-------------|--------------------|----------------------|
| 1122170 | 230V | 2x18V-2x0.16A | 40°C/35°C/B | - | 2x200mA/F |

| HOMOLOGACIONES |
|---------------------------------|
| UL Canada / UL USA / VDE / RoHS |

MEASURES AND DIMENSIONS

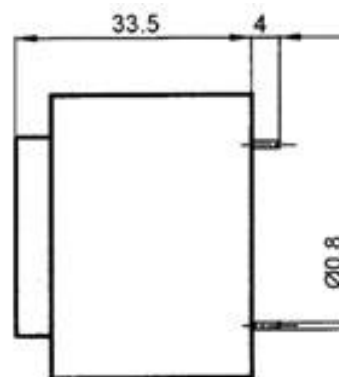
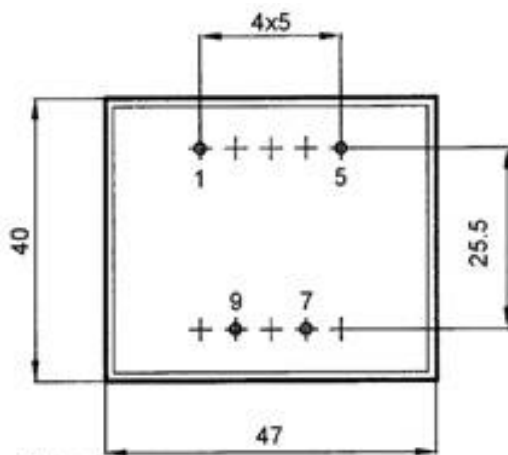

Pri. : 1-5 (115V or 230V)
1 Sec. : 7-9
2 Sec. : 6-7 / 9-10

ESQUEMA

Conexión 1 Secundario / 1 Secondary Connections

(Ejemplo / Example)
Esquema
Circuit arrangement
9V - 0.66A



Conexión 2 Secundarios / 2 Secondary Connections

Esquema
Circuit arrangement
2x9V - 2x0.33A



Conexión Serie
Serial connection
18V - 0.33A

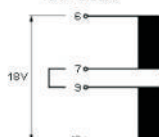

Conexión Paralelo
Parallel connection
9V - 0.66A

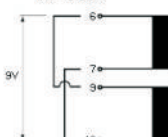

IMAGES

