

SY Long life and Low Impedance**Electrical characteristics:**

Working voltage 6,3 - 100V
Operating temperature: -40 + 105°C
Load life 3000 hours 4000 hours 5000 hours 6000 hours
at diameter 5 - 6,3mm 8 - 10x12mm 10x15 - 12mm 13 - 18mm
Shelf life 1000 hours at 105°C
Capacitance Range: 2.2 - 15.000 µF
Capacitance Tolerance: 20%
DC Leakage Current: 0,01 CV or 3µA

Dissipation factor: (120 Hz, 25°C)

WV (V)	6,3	10	16	25	35	50	63	100
tan	0.22	0.19	0.16	0.14	0.12	0.10	0.09	0.08

Pitch

D	5	6	8	10	13	16	18	22
Pitch	2	2,5	3,5	5	5	7,5	7,5	10
d	0,5	0,5	0,5	0,6	0,6	0,8	0,8	0,8

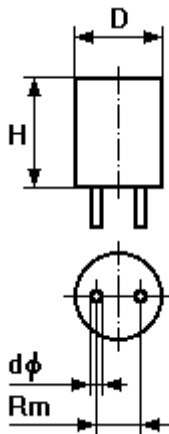

REV: 07.03.2007

Case size in mm

Capacitance/Voltage	6,3	10	16	25	35	50	63	100
µF/ V								
2,2						5x11		
4,7					5x11	5x11		
6,8								5x11
10					5x11	5x11		
15							5x11	6.3x11
22						5x11		
27								8x12
33					5x11	6.3x11	6.3x11	
39								8x15
47				5x11	6.3x11	6.3x11		10x12.5
56			5x11		6.3x11	6.3x11	8x12	8x20
68					6.3x11			10x16
82							8x15/10x12	10x20/13x16
100		5x11	6.3x11	6.3x11	6.3x11	8x11		10x25
120			6.3x11			8x15	8x20/10x16	10x30/13x20
150	5x11			8x11	8x11	10x12		16x16
180						8x20	10x20/13x16	13x25/18x16
220		6.3x11	6.3x11/8x11	8x11	8x15/10x12	10x16	10x25	13x30/16x20
270					8x20	10x19/13x15	10x30/13x20/16x16	13x35/16x25
330	6.3x11		8x11	8x15/10x12	10x16/10x20	10x20/10x25	13x25	13x40/18x20
390							18x16	16x32/18x25
470	6.3x11	8x11	8x15/8x20/10x12/10x16	8x20/10x12/10x16	10x19/13x15	10x30/13x20/16x15	13x30/16x20	16x36/18x32
560					10x25	13x25/18x15	13x35/16x25	16x40
680	8x11	8x15	8x20/10x16	10x19/13x15	10x30/13x20/16x15	13x30	13x40/18x20	18x36
820	10x12.5	10x12		10x25	13x20	13x35/16x20	16x32/18x25	18x40
1000	8x15	8x20/10x16	8x20/10x16/10x20/13x15	10x20/10x30/13x20/16x15	13x25/18x15	13x40/16x25/18x20	16x36/18x32	
1200	8x20/10x16	10x20	10x25	18x15	13x30/16x20	16x32/18x25	16x40	
1500	8x20/10x16/10x20	10x25/13x15	10x30/13x20/16x15	13x20/13x25	13x35	16x36		
1800	13x15			13x30/16x20	13x40/16x25/18x20	16x40/18x32		
2200	10x20/10x25	10x30/13x20/16x15	13x25/18x15	13x25/18x20	16x32/18x25	18x36		
2700	10x30/16x15	18x15	13x30/16x20	13x40/16x25	16x36/18x32	18x40		
3300	10x25/13x20	10x30/13x25	13x35	16x32/16x25	16x40/18x36			
3900	13x25/18x15	13x30/16x20	13x40/16x25/18x20	18x32	18x40			
4700	13x30	13x35	16x32/18x25	18x36				
5600	13x35/16x20	13x40/16x25/18x20	16x36/18x32	18x40				
6800	13x40/16x25/18x20	16x32/18x25	16x40					
8200	16x32	16x36/18x32	18x36					
10000	16x36/18x25	16x40/18x36	18x40					
12000	18x32	18x40						
15000	18x36							

REV: 07.03.2007

General Manager: Claudia Dinges
Value added tax no.: 121 859 595
District Cologne HRB B 40146
Tax no.: 203/5770/0270

Sachsstr. 6
Tel: +49 (2234)98 417-0
http://www.nova-elektronik.de

D-50259 Pulheim
Fax: +49 (2234)98 417-19
E-Mail: info@nova-elektronik.de