

SPECIFICATION FOR APPROVAL

REF : 20110401-B

PAGE: 1

PROD. NAME	RADIAL INDUCTOR	ABC'S DWG NO. ABC'S ITEM NO.	RB0914□□□□L□-□□□
---------------	------------------------	---------------------------------	------------------

I . CONFIGURATION & DIMENSIONS :

Marking :

" ● " : Start

● 101----100 uH (Inductance code)

A	: 8.7±0.5	m/m
B	: 12.0±1.0	m/m
C	: 25.0±5	m/m
D	: 18.0±5	m/m
E	: 2.5 max.	m/m
F	: 5.0±0.8	m/m
Wφ	: 0.65	m/m

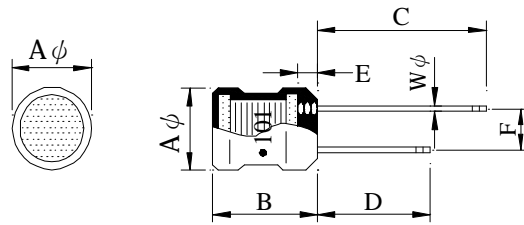

II . SCHEMATIC DIAGRAM :

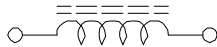

III . MATERIALS :

- a . Core : Ferrite DR core
- b . Wire : Enaelled copper wire (Class F)
- c . Lead : Sn/Ag/Cu
- d . Tube : Shrinkable tube 125°C , 600V
- e . Remark : Products comply with RoHS' requirements

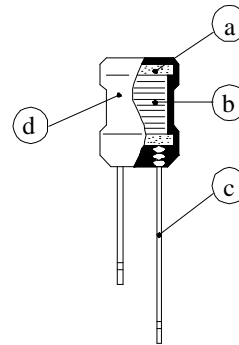

IV . GENERAL SPECIFICATION :

- a . Temp. rise : 20°C max. at rated current.
- b . Storage temp. : -40°C ---- +105°C
- c . Operating temp. : -40°C ---- +105°C

AR-001A

SPECIFICATION FOR APPROVAL

REF : 20110401-B

PAGE: 2

PROD. NAME	RADIAL INDUCTOR	ABC'S DWG NO.	RB0914□□□□L□-□□□
		ABC'S ITEM NO.	

V . ELECTRICAL CHARACTERISTICS :

DWG No.	Indutance (μ H)	Q min.	Test Freq. (MHz)		SRF (MHz) min.	RDC (Ω) max.	IDC (A) max.
			L	Q			
RB09143R3ML□-□□□	3.3 \pm 20%	20	7.96		70.0	0.027	3.60
RB09144R7ML□-□□□	4.7 \pm 20%	20	7.96		50.0	0.033	3.20
RB09146R8ML□-□□□	6.8 \pm 20%	20	7.96		30.0	0.039	3.00
RB0914100KL□-□□□	10.0 \pm 10%	50	2.52		20.0	0.048	2.70
RB0914120KL□-□□□	12.0 \pm 10%	50	2.52		15.0	0.055	2.50
RB0914150KL□-□□□	15.0 \pm 10%	50	2.52		10.0	0.060	2.40
RB0914180KL□-□□□	18.0 \pm 10%	40	2.52		9.5	0.065	2.30
RB0914220KL□-□□□	22.0 \pm 10%	40	2.52		9.0	0.090	1.90
RB0914270KL□-□□□	27.0 \pm 10%	40	2.52		8.5	0.110	1.80
RB0914330KL□-□□□	33.0 \pm 10%	40	2.52		8.0	0.120	1.70
RB0914390KL□-□□□	39.0 \pm 10%	30	2.52		7.0	0.130	1.60
RB0914470KL□-□□□	47.0 \pm 10%	30	2.52		6.0	0.140	1.50
RB0914560KL□-□□□	56.0 \pm 10%	30	2.52		5.0	0.200	1.30
RB0914680KL□-□□□	68.0 \pm 10%	30	2.52		4.5	0.210	1.20
RB0914820KL□-□□□	82.0 \pm 10%	30	2.52		4.0	0.230	1.10
RB0914101KL□-□□□	100.0 \pm 10%	30	0.796		3.5	0.280	1.00
RB0914121KL□-□□□	120.0 \pm 10%	30	0.796		3.0	0.320	0.90
RB0914151KL□-□□□	150.0 \pm 10%	30	0.796		2.8	0.370	0.80
RB0914181KL□-□□□	180.0 \pm 10%	30	0.796		2.6	0.540	0.75
RB0914221KL□-□□□	220.0 \pm 10%	30	0.796		2.4	0.600	0.70
RB0914271KL□-□□□	270.0 \pm 10%	20	0.796		2.2	0.680	0.65
RB0914331KL□-□□□	330.0 \pm 10%	20	0.796		2.0	0.760	0.60
RB0914391KL□-□□□	390.0 \pm 10%	20	0.796		1.9	0.850	0.55
RB0914471KL□-□□□	470.0 \pm 10%	20	0.796		1.8	1.300	0.50
RB0914561KL□-□□□	560.0 \pm 10%	20	0.796		1.7	1.400	0.45
RB0914681KL□-□□□	680.0 \pm 10%	20	0.796		1.6	1.600	0.40
RB0914821KL□-□□□	820.0 \pm 10%	20	0.796		1.5	1.800	0.35
RB0914102KL□-□□□	1000.0 \pm 10%	40	0.252		1.3	2.100	0.30

1). □ : Packafing information... Bulk

2). "- □□□":Reference code

SPECIFICATION FOR APPROVAL

REF: 20110401-B

PAGE: 3

PROD. NAME	RADIAL INDUCTOR	ABC'S DWG NO.	RB0914□□□□L□-□□□
		ABC'S ITEM NO.	

VI . TAPED PACKAGE DIMENSIONS :

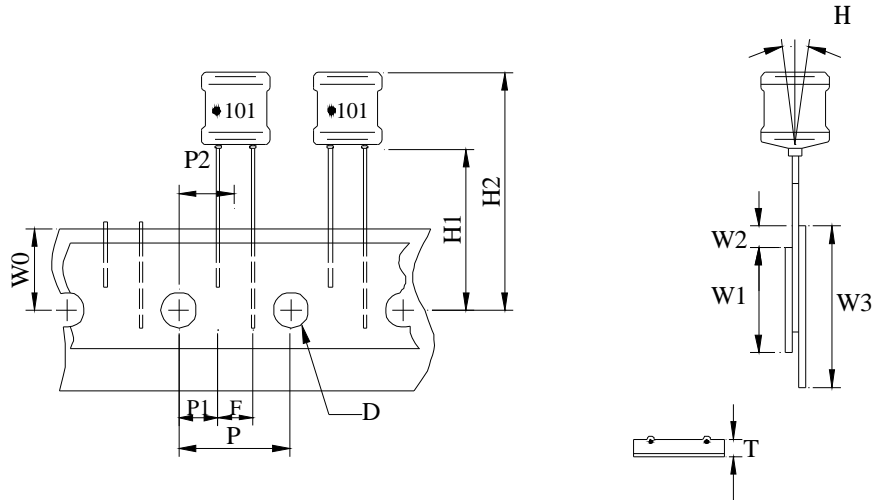

※ 500 PCS / REEL

ITEM	SYMBOL	SPECIFICATION			
		MILIMETER		INCH	
		SIZE	TOLERANCE	SIZE	TOLERANCE
TAPE FEED HOLE DIAMETER	D	4.00	±0.20	0.157	±0.008
COMPONENT LEAD PITCH	F	5.00	±0.50	0.200	±0.020
FRONT-TO-REAR DEFLECTION	H	2.00	MAX.	0.079	MAX.
FEED HOLE TO BOTTOM OF COMPONENT	H1	18.50	±0.80	0.728	±0.040
FEED HOLE TO OVERALL COMPONENT HEIGHT	H2	32.50	MAX.	1.280	MAX.
FEED HOLE PITCH	P	12.70	±0.30	0.500	±0.012
LEAD LOCATION	P1	3.85	±0.70	0.152	±0.028
CENTER OF COMPONENT LOCATION	P2	6.35	±1.30	0.250	±0.051
OVERALL TAPED PACKAGE THICKNESS	T	1.42	MAX.	0.056	MAX.
FEED HOLE LOCATION	W0	9.00	±0.50	0.354	±0.020
ADHESIVE TAPE WIDTH	W1	15.00	±0.50	0.598	±0.020
ADHESIVE TAPE POSITION	W2	4.00	MAX.	0.157	MAX.
TAPE WIDTH	W3	18.00	±0.50	0.709	±0.020

AR-001A

SPECIFICATION FOR APPROVAL

REF : 20110401-B

PAGE: 4

PROD. NAME	RADIAL INDUCTOR	ABC'S DWG NO.	RB0914□□□□L□-□□□
		ABC'S ITEM NO.	

VII . DWGING NUMBER EXPRESSION :

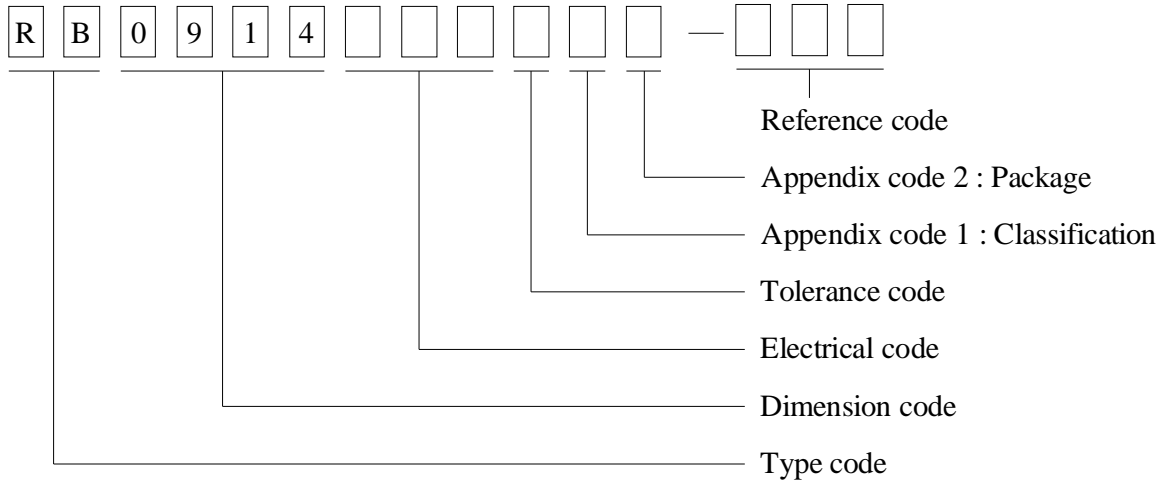

Appendix code 1 : Product Classification

- L : Lead Free Standard products comply with RoHS' requirements
- 1 ~ 9 : Lead Free Special products comply with RoHS' requirements

Appendix code 2 : Package Information

Code	Inner package	Inner package QTY	Remark
A	Tray	200 pcs	
B	Bag	100 pcs	
C	T.B.D.	T.B.D.	
D	T / R (Reel Package)	500 pcs	

SPECIFICATION FOR APPROVAL

REF : 20110401-B

PAGE: 5

PROD. NAME	RADIAL INDUCTOR	ABC'S DWG NO.	RB0914□□□□L□-□□□
		ABC'S ITEM NO.	

VIII . UL CARD :

OBMW2 September 8, 2000
Magnet Wire-Component

JUNG SHING WIRE CO LTD E174837
231 CHUNG CHENG RD, SEC 3 JEN-TEH HSIANG, TAINAN
HSIEN TAIWAN

Mtl Dsg	Mark Dsg	BC	Coat Typ	OC	ANSI Type	Temp Class
AIW	---	Polyamideimide		---	MW81-C	220
CFUEWB	---	Polyurethane		---	MW75C	130
EIAIW	---	Polyesterimide	Polyamideimide	---	MW35C	200
EILOCKY	---	Polyesterimide	Polyamide	---	---	180
EILOCKW	---	Polyesterimide	Modified Epoxy	---	---	200
EIW	---	Polyesterimide		---	---	220
EIW-2	---	Polyesterimide		---	MW74-C	200
FL.EILOCKY	---	Modified Polyester	Polyamide	---	---	155
L.SFFW	---	Polyurethane		---	MW79-C	155
LSUEW	---	Polyurethane		---	---	130
PEW	---	Polyester		---	---	155
PEY	---	Polyester	Nylon	---	MW24-C	155
SF.FLW	---	Modified Polyester		---	MW26C	155
SF.EIW	---	Polyesterimide		---	MW77C	180
SF.BY@	---	Modified Polyester	Nylon	---	MW27-C	155
SF.FLY@	---	Modified Polyester	Nylon	---	MW27-C	155
SF.BLOCKBS	---	Modified Polyester	Modified Polyamide	---	---	155
SF.EILOCKY#	---	Polyesterimide	Polyamide	---	---	180
SF.EILOCKBS	---	Polyesterimide	Modified Polyamide	---	---	180
SF.BW@	---	Modified Polyester		---	MW26C	155
SFFW	---	Polyurethane		---	MW79	155

287806002 Page 1 of 2

A not-for-profit organization
dedicated to public safety and
committed to quality service

Mtl Dsg	Mark Dsg	BC	Coat Typ	OC	ANSI Type	Temp Class
SFFY	---	Polyurethane		Polyamide	MW80C	155
UEW-1	---	Polyurethane		---	MW2-C	105
UEW-2	---	Polyurethane		---	---	130
UEW-4	---	Polyurethane		---	MW75C	130
UEY	---	Polyurethane		Nylon	MW28-C	130
UEY-2	---	Polyurethane		Polyamide	MW28-C	130

287806002 Page 2 of 2

OBMW2/E174837
September 8, 2000

AR-001A

