

DIGITAST

Microminiature SPDT, Key Switches



Features/Benefits

- High reliability / long life
- Designed for low level switching
- Ready to implement on PCB
- Latching function available
- Several button options

Typical Applications

- Medical
- Instrumentation
- Industrial electronics
- Audio electronics

Construction

FUNCTION: momentary or push-push
 CONTACT ARRANGEMENT: 1 change over contact SPDT, NO
 MODE OF SWITCHING: Non-shorting
 DISTANCE BETWEEN BUTTON CENTERS:
 HORIZONTAL MINIMUM: 12,7 (0.500) or 17,78 (0.700)
 VERTICAL MINIMUM: 17,78 (0.700)
 TERMINALS: PC pins
 MOUNTING: Soldering, centering pins

Mechanical

TOTAL TRAVEL: ≤ 3 (.0018)
 SWITCHING TRAVEL: 1,5 (0.0591)
 LATCHING TRAVEL: 1,8 (0.0709)
 OPERATING FORCE: 1.5 +/- 0.5 N (150 +/- 50 grams)

Process

SOLDERABILITY: Sealed contacts
 Max. soldering time and temperature: 5 s at 260°C

Electrical

SWITCHING POWER MAX.: 240 mW DC
 SWITCHING VOLTAGE MAX.: 24 V DC
 SWITCHING CURRENT MAX.: 10 mA DC
 SPACING CURRENT AT 20°C (push-push version): 100 mA
 DIELECTRIC STRENGTH (50 Hz, 1 min): 500 V
 OPERATING LIFE with or without max. switching power
 Momentary: $\geq 5 \times 10^6$ operations
 Push-push: $\geq 5 \times 10^5$ operations
 CONTACT RESISTANCE: Initial ≤ 50 m Ω
 After 5×10^6 operations: ≤ 100 m Ω
 INSULATION RESISTANCE: $\geq 10^{10}$ Ω
 CAPACITANCE at f= 10 kHz: ≤ 0.8 pF
 BOUNCE TIME: ≤ 2.5 ms
 Operating speed 400 mm/s (15.75/s)

Environmental

OPERATING TEMPERATURE: -25°C to 85°C.

How To Order

Our easy build-a-switch concept allows you to mix and match options to create the switch you need. To order, select desired option from each category and place it in the appropriate box.

Switch with Button

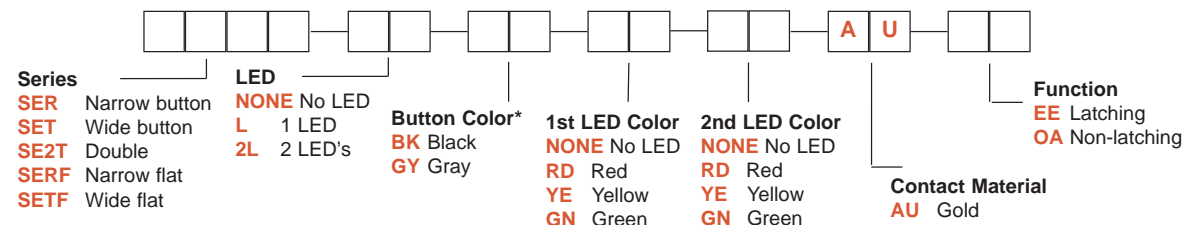

Button Only

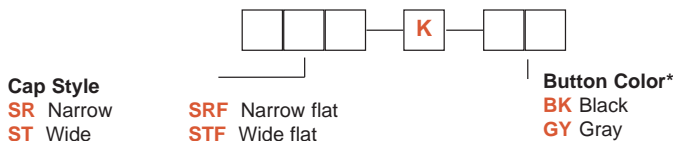

* Additional button colors available by request



D

Key Switches

DIGITAST Microminiature SPDT, Key Switches

DESIGNATION 

SER Narrow button

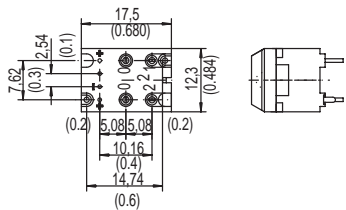

SER

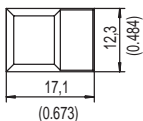

SERL

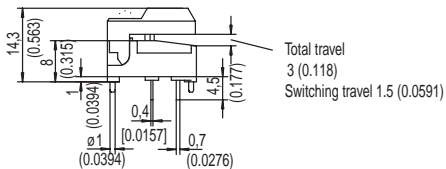

SER2L

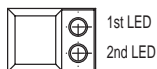

SET Wide button

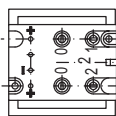

SET

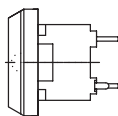
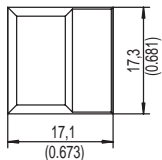

SETL

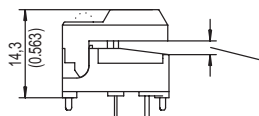

SET2L

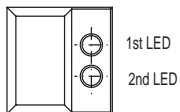

Total travel
3 (0.118)
Switching travel 1.5 (0.0591)



SE2T Double

SE2T, SE2TL, SE2T2L

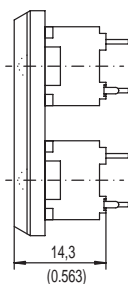
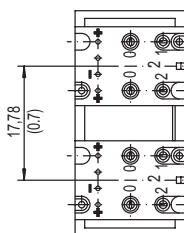

DIGITAST Microminiature SPDT, Key Switches

DESIGNATION

SERF Narrow flat

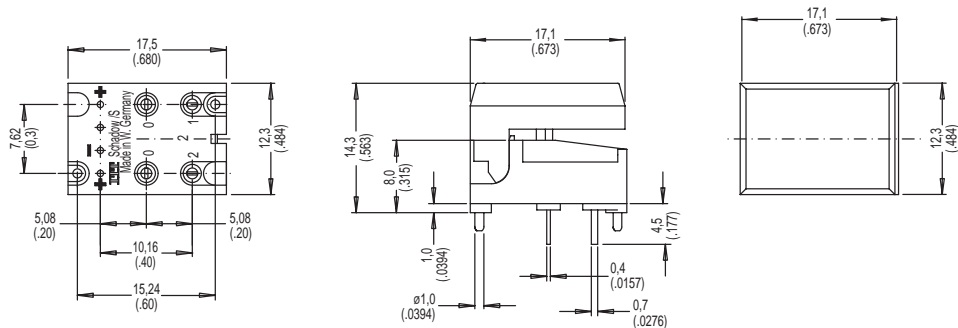

SETF Wide flat

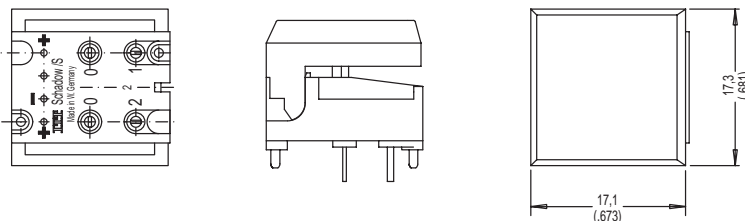

LED

NONE No LED

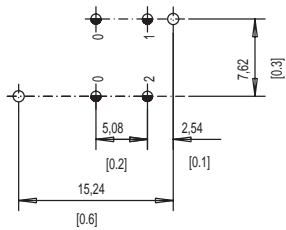

L 1 LEDs

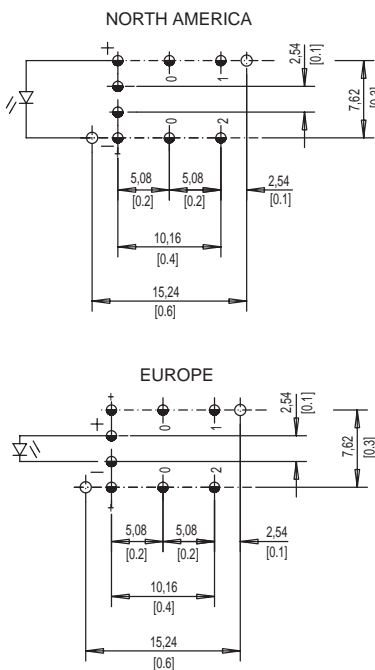

2L 2 LEDs

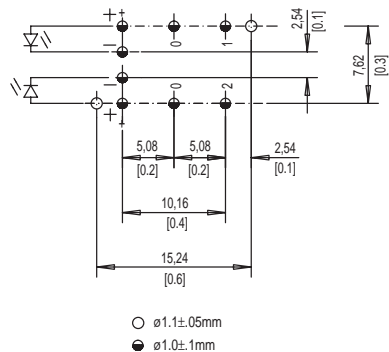

Soldering Side - Bottom View

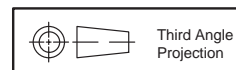

D

Key Switches

DIGITAST Microminiature SPDT, Key Switches

BUTTON COLOR

BK Black

GY Gray

Other button colors available by request (red (RD), green (GN), white (WH), yellow (YE), blue (BU), orange (OG)).

LED COLOR

OPTION CODE	COLOR
NONE	Models without LED
RD	Red
GN	Green
YE	Yellow

CONTACT MATERIAL

OPTION CODE	MATERIAL
AU	Gold

FUNCTION

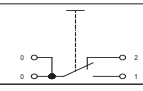
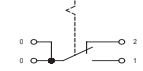
OPTION CODE	COLOR	SCHEMATIC
OA	Momentary	
EE	Push-Push	



D

Key Switches